

Product characteristic

ZQ series electric ball valve is a sphere around the center line of the body as a rotation to achieve an electric ball valve open and close. Sphere without support shaft, a sphere by two seats holding the "floating" state, it is mainly used for cutting on pipeline, distribution and change the flow direction of medium. With flow capacity coefficient of flow resistance is small, functional reliable performance, simple structure, convenient maintenance, long service life, etc. For a variety of fluid, such as gas liquid medium in the pipeline automatic opening and closing, so as to achieve program control systems and equipment or remote control, etc. Widely used in chemical, petroleum, natural gas, gas, metallurgy, power plant and other industries.

Working principle

ZQ Series electric ball valve divided into switch Type and modulate Type

ZQ series electric ball valve divided into 2-way type and 3-way type. The 2-way general type is divided into 2 pieces thread, 2 pieces flange, 3 pieces thread, 3-way divided into L type and T type.

ZQ series electric ball valve switch type, it use a 380 v/ 220 v/110 vac or 24 vdc as driving supply power, control of electric actuators are stem drive valve body ball 0° ~ 90° rotating ball valve opening and closing, realize the automatic control.

ZQ series electric modulating ball valve, it use a 380 v/ 220 v/110 vac as driving supply power, with 4 20 ma current signal or 0

10 v DC voltage signal to control signal, control electric actuators to spin valve rod drives the body ball to valve movement

required position, realize the automatic control.

Installation and using

1. The electric ball valve installations unprincipled requirements, but electric actuators in level state, the electric box cover is in the water flat or vertical status for the recommended installation form, it is good for soothing, debugging, maintenance and manual operation.
2. When installation should guarantee the space required for worker.
3. Connected to the flange body bolts shall be not less than 8.8 level on the richter scale are unlikely.
4. When the need to remove, should be the manual handwheel number of turns, the valve slightly open.
5. Installation, disassembly, commissioning shall not damage the sealing surface, cover tightly seal electrical cover should be tightened, in case of rain or moisture to enter.
6. Windows may not collide with hard objects.
7. When the valve is not often use, should be regular inspection and maintenance and operation, suggest that at least once a month.

Order attention

You should indicate the type specification when you order it, provide a detailed technical parameters, such as: operating mode (switch type or modulate type?) Voltage, medium, medium temperature, body material, max working pressure, orifice size, connection mode and size, environment temperature, etc.

ZQ series electric ball valve main technology parameter

1. Power voltage: AC220V / AC110V AC380V / 440v DC24V DC12VDC110V DC220V
2. Hole: 2M18
3. Medium temperature: - 20 C to 200°C
4. Fluid medium: water, oil, air and some corrosive liquid
5. Mode of action: switch type electric actuator drive valve body sphere to 0 C ~ 90° ± 10°
modulate type electric actuator body sphere rotates to the valve movement required position
6. Working pressure: standard 0 ~ 2.5 Mpa Optional 0 ~ 4.0 Mpa
7. Body material: standard SS304 (CF8) special made SS316 (CF8M)
8. DN size: DN15 ~ DN200
9. Connection type: thread connection 1/4" , 3/8" , 1/2" , 3/4" , 1" , 1 1/4" 1 1/2" 2" , 3" , 4" ,
standard DIN259/2999 Flange connection 15 F, 20F, 25F, 32 F, 40F, 50 F 65 F 80F
100F 125F 150F 200F standard GB9113

Product overview

2-pieces electric ball valve match SLX electric actuators suitable, have to input adopts the integration struction design the control signal and single-phase power supply can control operation Electric ball valve is a kind of 90° to Close the ball valve, flow capacity coefficient of flow resistance is small, strong function, small volume, reliable performance, structure Simple, easy maintenance, long service life, etc. Body channels and connection pipe diameter in the center of the same Online, through the medium can be almost no losses This product is often used for sealing of high demand Place, in addition to the general fluid control, but also particularly suitable to control sewage, viscous and containing particles, fine impurity of medium, which are widely used in food, environmental protection, light industry, oil, chemical teaching and research equipment Engineering, electric power industries such as industrial automatic control system.



Product characteristic

- 1.The body casting the use of advanced technology, reasonable structure, beautiful appearance.
- 2.Fluid resistance small, ball valve is the smallest of all valve fluid resistance class.
- 3.The seat sealing performance is good, use TEFLON as sealing ring, structure is easy to close Seal and ball valve sealing ability increases as the pressure medium.
- 4.As the seal ring has good lubrication, the sphere of the friction coefficient is small,extend the ball valve life.
- 5.Bottoms type valve stem and the head of valve stem head is special design, such as fire stem seal damage, the valve stem Convex sets and the body can also be formed between the metal contact, to ensure that the valve stem seal.

Valve Selection List

1			2	3	4	5	6	7	8
Dq83 Series			Body Connection mode	Voltage	Seal material	Body material	Pipe size	Orifice (mm)	Options
D	Q	83	S	A20	T	32	F	15	K
D= Electric	Q=Ball valve	83= 2-Way Thread 84= 2-Way High Temp Thread	S=3 Pieces	A10=AC110V A20=AC220V D24=DC24V	T=PTFE P=PPL (High Temp)	32=SS304 33=SS316 39= Cast steel	04=1/2" 05=3/4" 06=1" 07=1 1/4" 08=1 1/2" 09=2" 21=2 1/2" 23=3" 24=4"	15=15 20=20 25=25 35=35 40=40 50=50 65=65 80=80 100=100 125=125 150=150 200=200	K=(4-20mA or 0-10VDC

Valve Selection List

Size	Orifice mm	CV Facto	Operating Pressure Differential (bar)	Fluids Temp.	Actuator		L×W×H	Weight KG	Model Code 220VAC 50/60HZ
			Neutral gas, neutral liquids Petrochemical products, corrosive medium	℃	Voltage AC	Torque N · M			
1/2 "	15	4.5	0-25	0-120	220V	50	79×210	5.0	DQ83SA20T320415
								6.0	DQ83SA20T320415K
3/4 "	20	7.5	0-25	0-120	220V	50	82×217	5.0	DQ83SA20T320520
								6.0	DQ83SA20T320520K
1 "	25	12	0-25	0-120	220V	50	90×227	5.5	DQ83SA20T320625
								6.5	DQ83SA20T320625K
1 - 1/4 "	35	24	0-25	0-120	220V	80	112×230	6.5	DQ83SA20T320735
								7.0	DQ83SA20T320735K
1 - 1/2 "	40	29	0-25	0-120	220V	100	120×263	8.0	DQ83SA20T320840
								9.5	DQ83SA20T320840K
2 "	50	48	0-25	0-120	220V	150	144×270	9.5	DQ83SA20T320950
								11	DQ83SA20T320950K
2 - 1/2 "	65	52	0-25	0-120	220V	300	176×337	21	DQ83SA20T322165
								23	DQ83SA20T322165K
3 "	80	80	0-25	0-120	220V	400	200×363		DQ83SA20T322380
									DQ83SA20T322380K
4 "	100	128	0-25	0-120	220V	600	227×411		DQ83SA20T3224100
									DQ83SA20T3224100K

Dimensions

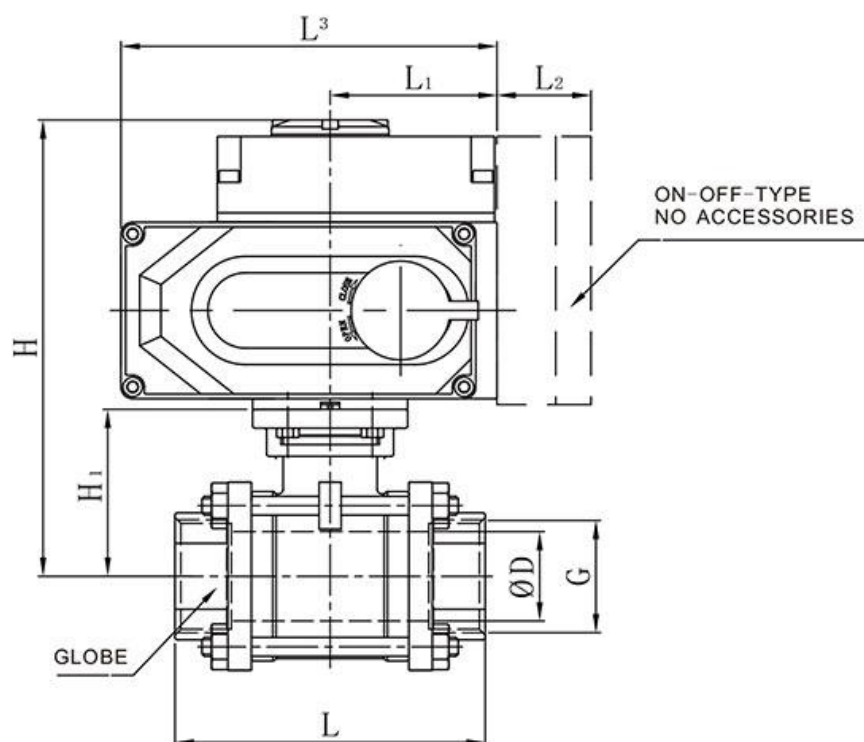

DN(mm)	SIZE (mm)							Mode code AC220V
	ΦD	L	H ₁	H	L ₁	L ₃	L ₂	
1/2"	15	79	42	155	50	123	--	DQ-003
				163	70	160	40	DQ-005K
3/4"	20	82	49	162	50	123	--	DQ-003
				170	70	160	40	DQ-005K
1"	25	90	59	172	50	123	--	DQ-003
				180	70	160	40	DQ-005K
1-1/4"	32	112	63	184	70	160	--	DQ-005
							40	DQ-005K
1-1/2"	38	120	71	192	70	160	--	DQ-008
							40	DQ-008K
2"	50	144	78	207	82	189	--	DQ-010
							40	DQ-010K
2-1/2"	65	176	100	264	116	268	--	DQ-030
							40	DQ-030K
3"	76	200	109	273	116	268	--	DQ-030
							40	DQ-030K
4"	100	227	140	304	116	268	--	DQ-040
							40	DQ-040K